

The Maxton Isolation Coupling's are comprised of two pipe flanges coupled by a threaded retainer ring. This design has increased strength and reduced weight at a lower cost. The threaded ring design provides superior strength because of the consistent sealing torque around the Thermoplastic Seal. Our insulators are created with the highest quality hybrid thermoplastic to provide superior noise / vibration reduction and metallic isolation. Maxton Isolation Couplings comply with ASME A17.1 / CSA B44.

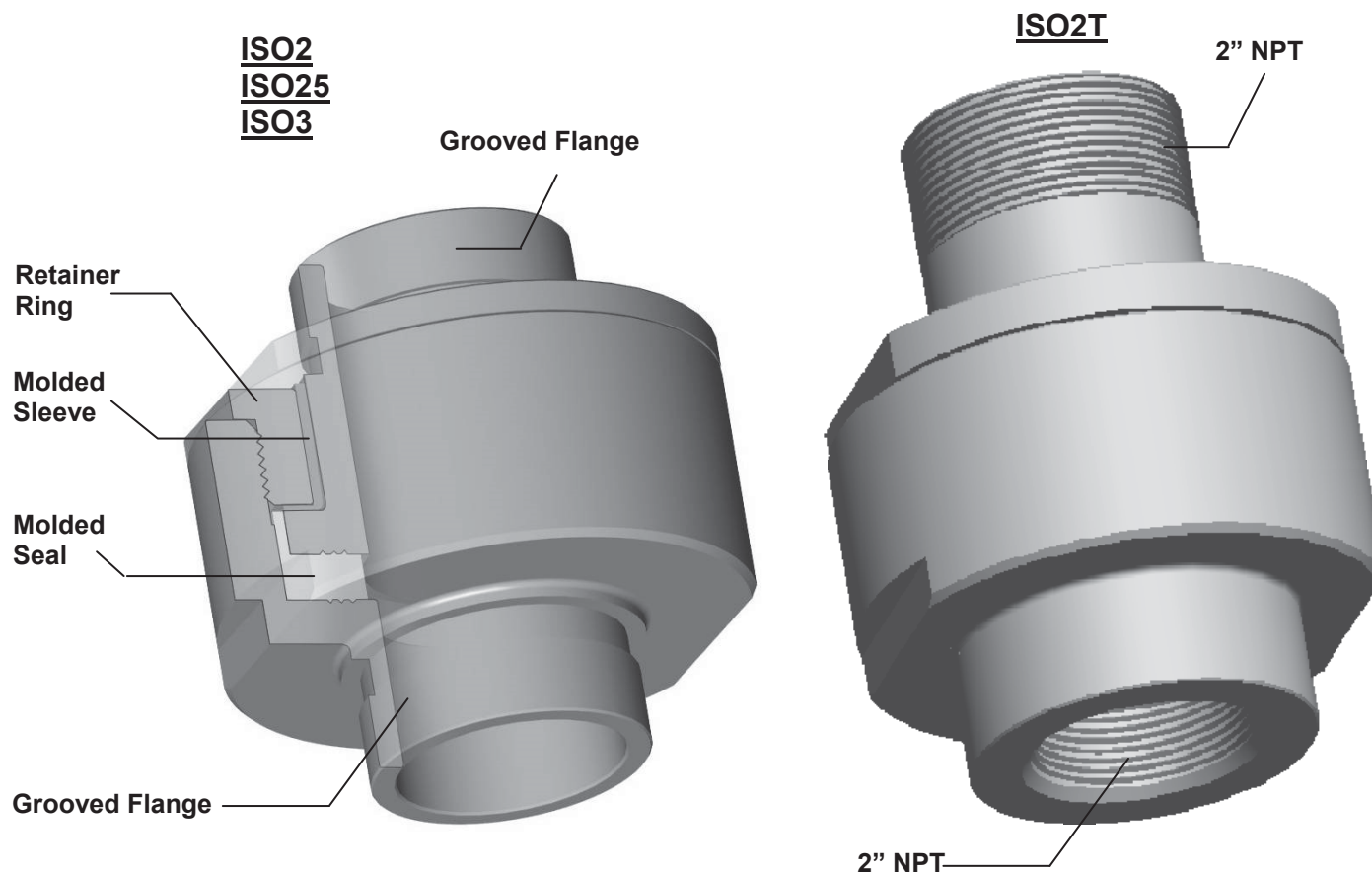

Specifications

Oil Type	Hydraulic Fluid
Maximum Operating Temperature	150° F (65° C)
Maximum Operating Pressure	1000 psi (69 bar)
Line Connections	2", 2.5", 3" Grooved or 2" NPT

	ISO2 2" Grooved	ISO2T 2" NPT	ISO25 2.5" Grooved	ISO3 3" Grooved
Maximum Flow Range	200 gpm (757 l/min)	200 gpm (757 l/min)	300 gpm (1135 l/min)	400 gpm (1514 l/min)
Overall Dimensions				
Width:	4 ½ in. dia. (115 mm)	4 ½ in. dia. (115 mm)	5 ¼ in. dia. (133 mm)	5 ¼ in. dia. (133 mm)
Length:	4 ¼ in. (108 mm)	5 ½ in. (140 mm)	4 ½ in. (115 mm)	4 ½ in. (115 mm)
Weight:	8.15 lbs. (3.65 kg)	8.85 lbs. (4.01 kg)	10.85 lbs. (4.92 kg)	10.05 lbs (4.55 kg)